

International Young Physicists' Tournament  
c/o European Physical Society  
6, rue des Frères Lumière  
68200 Mulhouse France  
email : [ilya.martchenko@iypt.org](mailto:ilya.martchenko@iypt.org)  
tel : +7 911 950 78 22

## 29th IYPT 2016: Inspector's Report

June 3, 2016

### Introduction

In line with the IYPT Hosting Agreement (p. 2.3), an Inspection to the premises of the 29th IYPT 2016 took place on May 30-31, 2016. The Inspection was carried out according to a detailed agenda agreed with the LOC and focused on the current status of the preparations. During specific parts of the two-day inspection, following persons took part at meetings, discussions, and visits to the premises:

- Vladimir Kruzhaev, Vice Rector for Science, UrFU
- Andrey Poltavets, Vice Rector for Information Technologies, UrFU
- Olga Inisheva, Deputy Director for Science, SUNC UrFU
- Irina Polyakova, Deputy Director, Inst. for Social and Political Sciences, UrFU
- Anna Boikova, Specialist for Project Management, UrFU
- Anna Krasnova, Director of the Center for Positioning and Brand Technologies, UrFU
- Roman Agrikov, Directorship for Information Technologies, UrFU
- Yulia Pyankova, Volunteer Coordinator, UrFU
- Nikolai Titov, Deputy Vice Rector for General Affairs, UrFU
- Natalya Rakultseva, Director for the Public Dining Facilities, UrFU
- Ilya Martchenko, Inspector from the Executive Committee, IYPT
- Timur Ibragimov, Assistant to the Inspector and Photographer

### Physics Fight rooms

All PFs will take part in the main University building (Ulitsa Mira, 19). The building is within a short walking distance from the Dormitory, however for those staying at the Hotel a bus transfer will be arranged. It is possible to enter the building only through the main entrance.

The building is very large and has a complex internal structure. It is emphasized that reaching some of the PF rooms from the main entrance or from the Office requires up to 9 minutes of walking via several corridors and staircases. The LOC (responsible person: Anna Krasnova) will mount a comprehensive navigation system in the building, giving directions to each PF room from all key places (Dining Halls, entrance, Office) and back, where needed. It is understood that this task is of a high importance. The University has expertise in preparing similar navigation systems. During the Inspection, each room was labeled A...I. With an expected 29 teams, it is nearly certain that at least seven three-teams groups and up to two four-team groups will be required.

Rooms A...G are ideal for three-team groups, while only rooms H and I can accommodate four-team groups. It has been discussed with Timotheus Hell that fight schedules will forcibly locate any four-team groups to H and I.

Two data projectors will be available per room, and the clock shall be displayed on an LCD panel. Detailed specifications of each room is given in the checklist.

The groups A...G are regular flat-floor classrooms, as depicted in the photos below. Some of them (B, D, F) allow for seating of 30 observers.



The groups H and I have large balconies allowing for taking excellent photos and videos of the Physics Fights, as depicted in the photo below. They have especially high seating capacity, allowing for over 50 observers.



PF rooms shall form three clusters, such that coffee breaks can be arranged for each cluster. Cluster A...C includes groups A (room И-310), B (room И-306) and C (room И-329). These three rooms are located within 1 or 2 minutes of walking from the IYPT office. Their positions on the level 3 of the building plan are depicted in the scheme below.

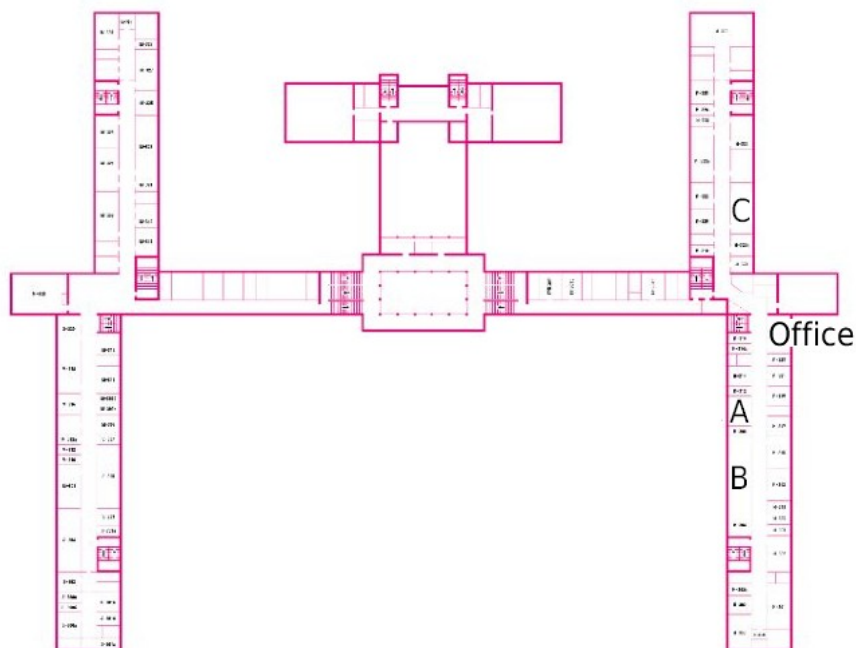

Cluster D...G includes groups D (room M-524a), E (room M-526), F (room M-527) and G (room M-538). Those four rooms are located within 8 or 9 minutes of walking from the IYPT office via a network of corridors and staircases. Their positions on the level 5 of the building plan are depicted in the scheme below.

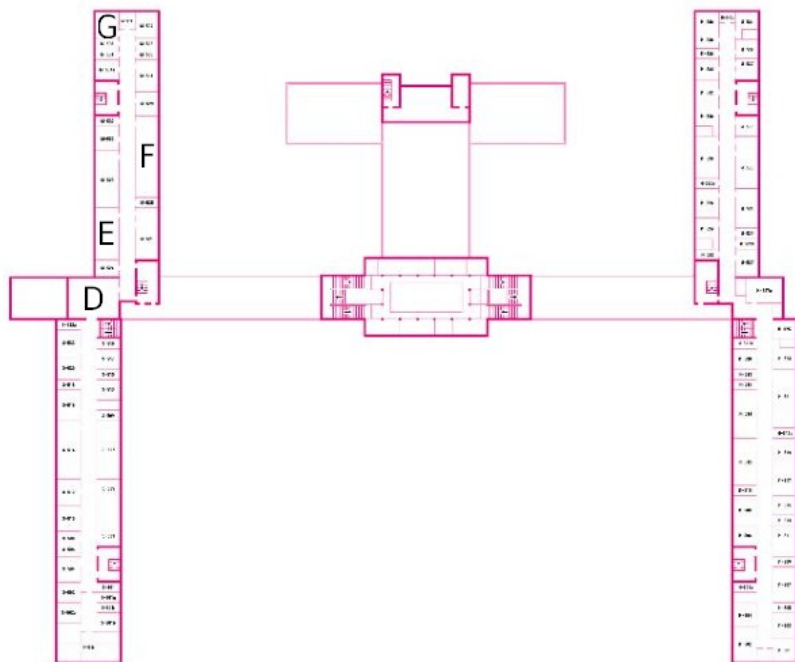

Cluster H...I includes groups H (room B-202) and I (room B-203) which are reading halls of the university library. Those two rooms are located within 8 minutes of walking from the IYPT office via a network of corridors and staircases. Their positions on the level 2 of the building plan are depicted in the scheme below.

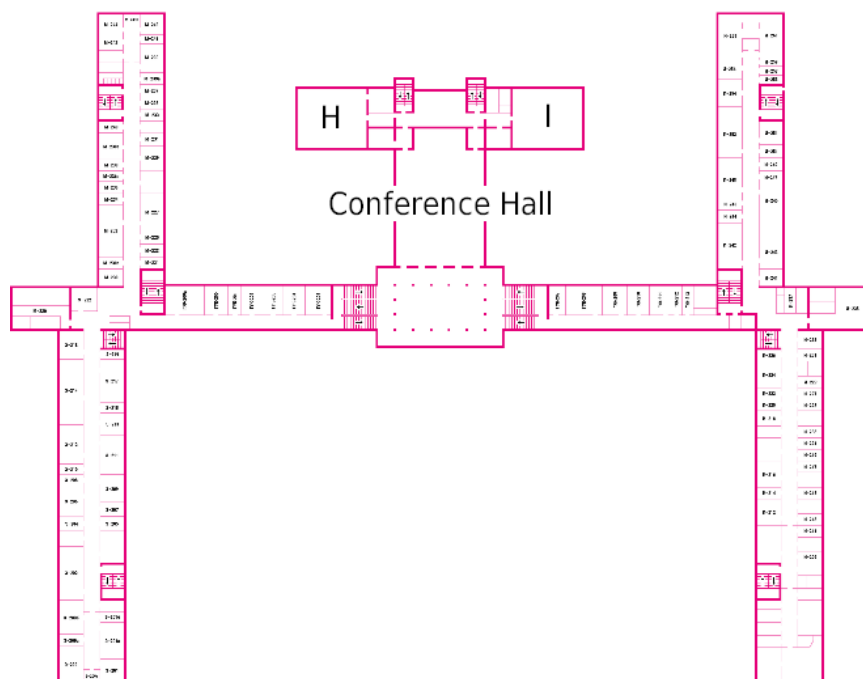

### Conference Hall for Opening and Closing Ceremonies

Opening and Closing Ceremonies shall be held in the Assembly Hall (room ГYK-206) with 700 seats and many wireless microphones. Detailed specifications of the Conference Hall is given in the checklist.



### **Jury Meeting**

Jury Meeting shall be held in the Academic Council Hall (room И-420) which is an amphitheater-type auditorium ideal for the meeting.

### **Toilets in the University building**

Toilets are available in many parts of the building and are generally marked with symbols “М” (gentlemen) and “Ж” (ladies). The toilets significantly vary in design and in standard. In many cases, the toilets for two genders are not next door, in particular those near Groups D...G. Directions will be given to the nearest toilets (with respect to each Physics Fight room and Dining Hall). Toilet paper, soap dispensers and paper towels will be provided in each toilet.

### **IYPT Office**

The Office used by Fight Administrators (Timotheus Hell, Max Lasserus and Michael Scherbela) will be in the room И-325 in the immediate vicinity of the groups A, B, and C.

Detailed specifications of the Office is given in the checklist. The Office will meet the requirements of the Fight Administrators, and the necessary equipment is either already available or will be purchased and brought to the office on time. There is a direct contact between Timotheus Hell and Andrey Poltavets who is responsible for the IT infrastructure of the university, During the visit to the Office, specific requirements were discussed with Roman Agrikov, Nikolai Titov, and Anna Krasnova.

### **Hotel Accommodation**

All independent jurors, EC members, and regular visitors will be accommodated at Park Inn by Radisson Ekaterinburg Hotel (Ulitsa Mamina-Sibiryaka 98). The hotel is ranked as four-stars and is of a sufficiently high standard.

An open W-Fi network provided by the Hotel is available in the entire building.

Distance between the Hotel and the University is ca. 3 km. Transfer to the University will be provided in buses. Depending on the traffic, the transfer may take ca. 10-15 minutes. Walking is not practical other than for sightseeing of central streets (Ulitsa Malysheva and Prospekt Lenina). If someone wishes to go to/from the University or the Dormitory on their own (e.g. late in the night), taxi should cost less than 200.- RUR (3.- EUR).



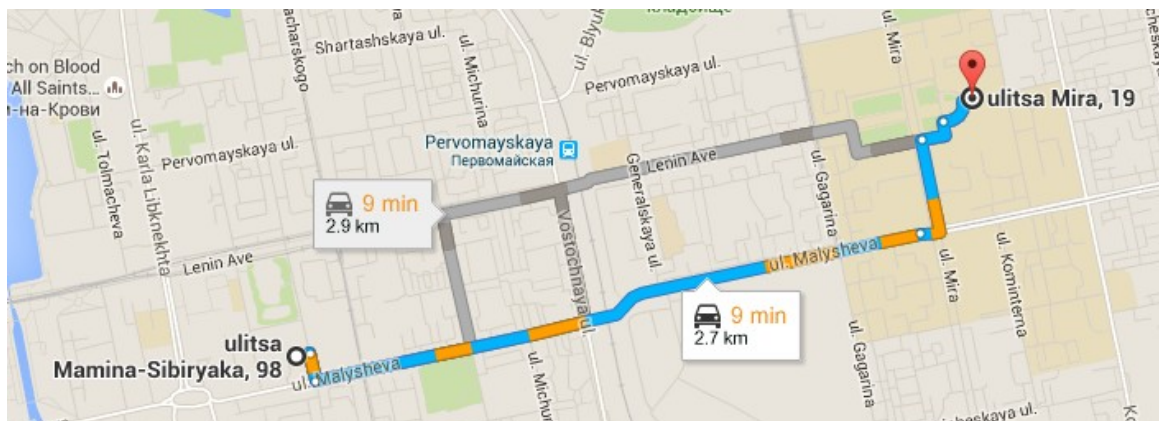

### Dormitory Accommodation

All team members, team leaders, and 'visitors in the dormitory' will be accommodated at the university dormitory No. 5 (Ulitsa Malysheva 144). The rooms are of a sufficiently high standard for a university dormitory. Three floors of the Dormitory (levels 5, 6, and 9) will be occupied by the IYPT participants. The building has two elevators and a staircase. There are two vending machines near the entrance selling chocolates, snacks, and drinks.



Nikolai Titov and Roman Agrikov took part in the visit and answered questions about the facilities. Two senior managers of the Dormitory joined the visit.

The Dormitory is located in the center of the city in the immediate vicinity of grocery stores, food kiosks, cafes, and similar.

All rooms are grouped in the units of two. A door from the corridor leads into a very small lobby which then has doors to bathroom, toilet, and the two rooms. There is a fridge in the lobby of each unit. Each room has three regular beds, tables, chairs, a balcony, and wardrobes. The LOC will allocate rooms in the best possible manner, taking into account preferences of the teams and gender of the members.





Towels and bed linen will be provided, and will be replaced one time during the IYPT. Toilet paper and shower gel (in bottles, rather than in wall-mounted dispensers) will be provided. Nine 220 V power outlets are available in each room, plus 4 outlets in the small lobby of the unit.

An open W-Fi network provided by the university is available in the entire building. During the inspection, the connection was fast and stable, however the LOC suggested that remote corners of some rooms may have weaker signal.

There will be only one key per room, and it is impossible to provide an individual room key per team member. Everyone is expected to leave the key at the reception when leaving the Dormitory.

The reception is staffed 24/7 and there will be two volunteers living in the dormitory and available for the teams at all times. The LOC plans to have an information desk in the dormitory with local volunteers available to help with any practical issue.

Access to the building is restricted between 01h00 and 06h00 in the night. While anyone coming from the outside during these hours will be allowed in, it is not clear what procedure is to leave the building during the night. On one hand, leaving the building in the night is not in line with the university regulations. On the other hand, it is understood by Ilya Martchenko that team leaders are responsible for personal security of underage participants and have the right to allow night walks. Vladimir Kruzhaev will discuss the matter with the legal office of the university to provide a best solution.

There are 4 basic kitchens per floor. Kettles, plastic cups, tea, and coffee will be provided in the kitchens.

A small gym is available on the ground floor.

There are 5 preparation lounges per floor, many with leather sofas. The lounges are rather small, have doors and can be used for team meetings, if needed. In an unlikely case that too many teams require such lounges, similar lounges are openly accessible on each floor of the Dormitory.



Distance between the entrance to the Dormitory and the entrance to the University is no more than 700 m, and probably less if shortcuts rather than large streets are used. It is estimated that walking from the Dormitory to the most remote PF group may take ca. 15 minutes.

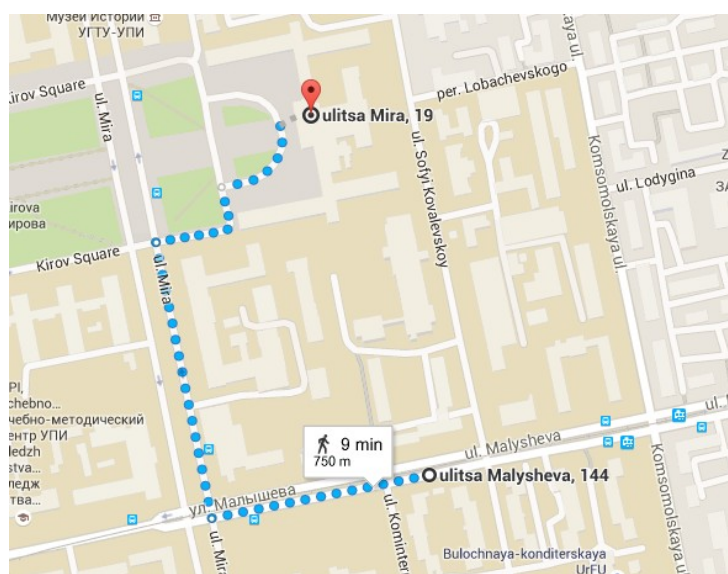

## Dining Halls for Lunches and Dinners

Natalya Rakultseva, Director for the Public Dining Facilities, took part in the visits and answered questions about the preparations and facilities.

Lunches and dinners will be provided in the university building in four Dining Halls, catering food simultaneously. These Halls are in different parts of the building, rather than next door to each other. Two of the Halls are of a smaller capacity (50 and 90 seating places, respectively) and will be used for EC, IOC, and independent jurors. Two other Halls are of a larger capacity (140 seating places each) and will be used for team members and team leaders. Each participant will be informed (e.g. via information in their name badge) on what Dining Hall they should use.

The working hours of the Dining Halls will be relatively flexible, giving chance to have a meal for the guests coming too early or too late (within ca. 30 min margins).



Convenient labels (e.g. 1...4) for each of the Dining Halls will be selected. Detailed specifications of each Dining Hall are given in the checklist.

European-style food will be served on buffet-type tables. Small tags explaining ingredients (e.g. beef or pork) will be provided. Vegetarian options will be available.

## Dining Halls for Breakfasts

Breakfasts will be served in the Hotel and in the Dormitory, respectively.

Breakfast in the Hotel meets the standards expected from an international four-star hotel. Restaurant of the Hotel is located on the ground floor in an open area within a few meters from the lobby and the entrance. Parking lot is well visible from the restaurant.

Breakfast in the Dormitory will be served on buffet-type tables, offering a reasonable selection of food. The Dining Hall in the Dormitory is located on the ground floor close to the elevators. Is it also possible to enter the Dining Hall from the outside via separate doors to the right of the main entrance.

## Physics Fight assistants

Olga Inisheva is responsible for recruiting volunteers who will act as Physics Fight assistants. Those are not the same persons as team guides. At the moment, 24 PF assistants have been selected, including ex-participants of the Russian YPT and UrFU students. It is understood that they will be split in pairs such that one is more experienced with the regulations and more fluent in English than the other one.

Some of the PF assistants are not from Ekaterinburg and will not be available until the last day. Timotheus Hell plans to have the final training and give accounts to Newtoon on June 26. Ilya Martchenko had a separate discussion with Olga Inisheva on the features and technical details of Newtoon.

## Team guides

Yulia Pyankova coordinates volunteers who will act as team guides. A lot of volunteers have been selected and underwent training. These guides will act as the first point of contact with the LOC in case of any questions or problems. It is expected that one team leader of each team will be given a local Russian SIM card to facilitate coordination with the volunteers.

## **Hotline**

The LOC suggested an idea to organize a 24/7 telephone hotline to deal with any urgent questions about the IYPT and irregular situations. Similar hotlines were organized by the university in the past. Olga Inisheva and Ilya Martchenko were pleased to make clear that “any urgent questions about the IYPT” must not include questions on the physics of the problems.

## **Current status of the preparations**

As of now, it is expected that 29 teams take part at the IYPT. Anna Boikova coordinates with the teams to assist with securing Russian visas and is in contact with the Russian Ministry of Foreign Affairs. While we are short on time, no significant problems are expected.

A large and well-coordinated group takes care about logistics and local preparations and is in direct contact with Timotheus Hell and Ilya Martchenko.

## **Transportation and arrival**

Koltsovo International Airport (SVX) is located within 20 km of the city center. The waiting time at the airport should be small, and the LOC is well experienced with handling airport meet-and-greet. Teams are asked to submit their arrival details in CURIE as early as possible. During the check-in at the Dormitory, participant bags and badges will be distributed.

EC members are expected to arrive early enough on June 26 to allow for a short meeting. Timotheus Hell and his assistants will arrive to Ekaterinburg earlier to make final local preparations for the Physics Fights administration.

## **IOC meeting**

The IOC meeting will take place at Ramada Yekaterinburg Hotel & Spa. IOC members will be transferred from either Park Inn Hotel or Dormitory to this location. It was not possible to inspect Ramada, however it is understood that this is a high standard hotel with sufficient facilities for a normal IOC meeting.

## **Conclusion**

By submitting this report, the Inspector Ilya Martchenko can confirm that the preparation runs smoothly and efficiently and there are no considerable risks associated with the 29th IYPT 2016. Tasks requiring a special LOC attention have been discussed and outlined in this report. A well-executed IYPT is to be expected.



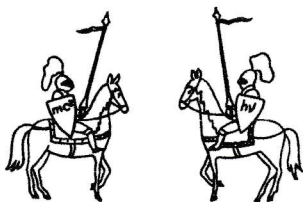

International Young Physicists' Tournament  
c/o European Physical Society  
6, rue des Frères Lumière  
68200 Mulhouse France  
email : ilya.martchenko@iypt.org  
tel : +7 911 950 78 22

## 29th IYPT 2016 PF Room inspection checklist

Room door number	U-310 (very close to office)
Tentative Group code	A
External navigation signs	<input type="checkbox"/> extensive <input type="checkbox"/> satisfactory <input checked="" type="checkbox"/> not yet mounted
Room type	<input checked="" type="checkbox"/> regular classroom <input type="checkbox"/> conference hall <input type="checkbox"/> library <input type="checkbox"/> amphitheater
Capacity teams (9.2, 9.3, 9.4)	<input checked="" type="checkbox"/> 3 teams only <input type="checkbox"/> 4 teams
Visitors (9.2, 9.3, 9.4)	chairs and space allow for seating of <u>10</u> visitors
Access for general public	<input type="checkbox"/> yes <input checked="" type="checkbox"/> only with an IYPT badge for pre-registered visitors
Data projectors (9.5)	ceiling mount projectors: <u>2</u> pcs portable projectors to be brought into the room: <u>0</u> pcs
PC for fight assistants (9.6)	<input checked="" type="checkbox"/> already in the room <input type="checkbox"/> will be brought later
External monitor for clock	<input checked="" type="checkbox"/> LCD panel in the room <input type="checkbox"/> data projector <input type="checkbox"/> will be brought later
Microphones	<input type="checkbox"/> no <input checked="" type="checkbox"/> yes, <u>1</u> pcs <u>fixed</u>
Boards / flipcharts (9.5)	<input checked="" type="checkbox"/> wall mount board <input checked="" type="checkbox"/> flipcharts to be brought into room
220 V power outlets (9.5)	<input checked="" type="checkbox"/> one power outlet per team member near their table
Wi-Fi connectivity	<input type="checkbox"/> no <input type="checkbox"/> yes, open <input checked="" type="checkbox"/> yes, restricted with password: <u>_____</u>
Accessibility of protocols	<input checked="" type="checkbox"/> http <input checked="" type="checkbox"/> SSH on port 22 <input type="checkbox"/> ftp
Coffee breaks (7.2)	<input checked="" type="checkbox"/> near the door <input type="checkbox"/> in cafeteria <input type="checkbox"/> another place: <u>_____</u>
Nearest toilet	average walking takes <u>4</u> minutes to reach the toilet <input type="checkbox"/> navigation signs to the toilet <input type="checkbox"/> toilet paper dispensers ? <input type="checkbox"/> soap dispensers <input type="checkbox"/> hand dryers <input type="checkbox"/> paper towels
Walking distance to office	average walking takes <u>1</u> minutes to reach the IYPT office

Date

30.05.2016

Inspector's signature

LOC signature

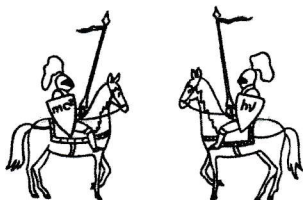

International Young Physicists' Tournament  
c/o European Physical Society  
6, rue des Frères Lumière  
68200 Mulhouse France  
email : [ilya.martchenko@iypt.org](mailto:ilya.martchenko@iypt.org)  
tel : +7 911 950 78 22

## 29th IYPT 2016 PF Room inspection checklist

Room door number	U-306 (very close to office)
Tentative Group code	B
External navigation signs	<input type="checkbox"/> extensive <input type="checkbox"/> satisfactory <input checked="" type="checkbox"/> not yet mounted
Room type	<input checked="" type="checkbox"/> regular classroom <input type="checkbox"/> conference hall <input type="checkbox"/> library <input type="checkbox"/> amphitheater
Capacity teams (9.2, 9.3, 9.4)	<input checked="" type="checkbox"/> 3 teams only <input type="checkbox"/> 4 teams (if needed, can be 4)
Visitors (9.2, 9.3, 9.4)	chairs and space allow for seating of 30 visitors
Access for general public	<input type="checkbox"/> yes <input checked="" type="checkbox"/> only with an IYPT badge for pre-registered visitors
Data projectors (9.5)	ceiling mount projectors: 1 pcs portable projectors to be brought into the room: 1 pcs
PC for fight assistants (9.6)	<input checked="" type="checkbox"/> already in the room <input type="checkbox"/> will be brought later
External monitor for clock	<input checked="" type="checkbox"/> LCD panel in the room <input type="checkbox"/> data projector <input type="checkbox"/> will be brought later
Microphones	<input type="checkbox"/> no <input type="checkbox"/> yes, 1 pcs fixed
Boards / flipcharts (9.5)	<input checked="" type="checkbox"/> wall mount board <input checked="" type="checkbox"/> flipcharts to be brought into room
220 V power outlets (9.5)	<input checked="" type="checkbox"/> one power outlet per team member near their table
Wi-Fi connectivity	<input type="checkbox"/> no <input type="checkbox"/> yes, open <input checked="" type="checkbox"/> yes, restricted with password: _____
Accessibility of protocols	<input checked="" type="checkbox"/> http <input checked="" type="checkbox"/> SSH on port 22 <input type="checkbox"/> ftp
Coffee breaks (7.2)	<input checked="" type="checkbox"/> near the door <input type="checkbox"/> in cafeteria <input type="checkbox"/> another place: _____
Nearest toilet	average walking takes 1 minutes to reach the toilet <input type="checkbox"/> navigation signs to the toilet <input type="checkbox"/> toilet paper dispensers <input type="checkbox"/> soap dispensers <input type="checkbox"/> hand dryers <input type="checkbox"/> paper towels
Walking distance to office	average walking takes 2 minutes to reach the IYPT office

Date

30.05.2016

Inspector's signature

LOC signature



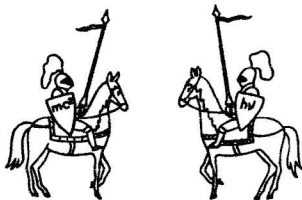

International Young Physicists' Tournament  
c/o European Physical Society  
6, rue des Frères Lumière  
68200 Mulhouse France  
email : [ilya.martchenko@iypt.org](mailto:ilya.martchenko@iypt.org)  
tel : +7 911 950 78 22

## 29th IYPT 2016 PF Room inspection checklist

Room door number	u-329 (very close to office)
Tentative Group code	C
External navigation signs	<input type="checkbox"/> extensive <input type="checkbox"/> satisfactory <input checked="" type="checkbox"/> not yet mounted
Room type	<input checked="" type="checkbox"/> regular classroom <input type="checkbox"/> conference hall <input type="checkbox"/> library <input type="checkbox"/> amphitheater
Capacity teams (9.2, 9.3, 9.4)	<input checked="" type="checkbox"/> 3 teams only <input type="checkbox"/> 4 teams
Visitors (9.2, 9.3, 9.4)	chairs and space allow for seating of <u>10</u> visitors
Access for general public	<input type="checkbox"/> yes <input checked="" type="checkbox"/> only with an IYPT badge for pre-registered visitors
Data projectors (9.5)	ceiling mount projectors: <u>2</u> pcs portable projectors to be brought into the room: <u>0</u> pcs
PC for fight assistants (9.6)	<input checked="" type="checkbox"/> already in the room <input type="checkbox"/> will be brought later
External monitor for clock	<input checked="" type="checkbox"/> LCD panel in the room <input type="checkbox"/> data projector <input type="checkbox"/> will be brought later
Microphones	<input type="checkbox"/> no <input type="checkbox"/> yes, <u>1</u> pcs <u>fixed</u>
Boards / flipcharts (9.5)	<input checked="" type="checkbox"/> wall mount board <input checked="" type="checkbox"/> flipcharts to be brought into room
220 V power outlets (9.5)	<input checked="" type="checkbox"/> one power outlet per team member near their table
Wi-Fi connectivity	<input type="checkbox"/> no <input checked="" type="checkbox"/> yes, open <input checked="" type="checkbox"/> yes, restricted with password: <u>---</u>
Accessibility of protocols	<input checked="" type="checkbox"/> http <input type="checkbox"/> SSH on port 22 <input type="checkbox"/> ftp
Coffee breaks (7.2)	<input checked="" type="checkbox"/> near the door <input type="checkbox"/> in cafeteria <input type="checkbox"/> another place: <u>---</u>
Nearest toilet	average walking takes <u>9</u> minutes to reach the toilet <input type="checkbox"/> navigation signs to the toilet <input type="checkbox"/> toilet paper dispensers <input type="checkbox"/> soap dispensers <input type="checkbox"/> hand dryers <input type="checkbox"/> paper towels
Walking distance to office	average walking takes <u>2</u> minutes to reach the IYPT office

Date

30.05.2016

Inspector's signature

LOC signature

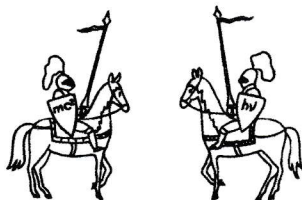

International Young Physicists' Tournament  
c/o European Physical Society  
6, rue des Frères Lumière  
68200 Mulhouse France  
email : [ilya.martchenko@iypt.org](mailto:ilya.martchenko@iypt.org)  
tel : +7 911 950 78 22

## 29th IYPT 2016 PF Room inspection checklist

Room door number	M-524 A
Tentative Group code	D
External navigation signs	<input type="checkbox"/> extensive <input type="checkbox"/> satisfactory <input checked="" type="checkbox"/> not yet mounted
Room type	<input checked="" type="checkbox"/> regular classroom <input type="checkbox"/> conference hall <input type="checkbox"/> library <input type="checkbox"/> amphitheater
Capacity teams (9.2, 9.3, 9.4)	<input checked="" type="checkbox"/> 3 teams only <input type="checkbox"/> 4 teams (if needed, can be 4)
Visitors (9.2, 9.3, 9.4)	chairs and space allow for seating of 30 visitors
Access for general public	<input type="checkbox"/> yes <input checked="" type="checkbox"/> only with an IYPT badge for pre-registered visitors
Data projectors (9.5)	ceiling mount projectors: 2 pcs portable projectors to be brought into the room: 0 pcs
PC for fight assistants (9.6)	<input checked="" type="checkbox"/> already in the room <input type="checkbox"/> will be brought later
External monitor for clock	<input checked="" type="checkbox"/> LCD panel in the room <input type="checkbox"/> data projector <input type="checkbox"/> will be brought later
Microphones	<input type="checkbox"/> no <input checked="" type="checkbox"/> yes, 1 pcs fixed
Boards / flipcharts (9.5)	<input checked="" type="checkbox"/> wall mount board <input checked="" type="checkbox"/> flipcharts to be brought into room
220 V power outlets (9.5)	<input checked="" type="checkbox"/> one power outlet per team member near their table
Wi-Fi connectivity	<input type="checkbox"/> no <input type="checkbox"/> yes, open <input type="checkbox"/> yes, restricted with password: _____
Accessibility of protocols	<input checked="" type="checkbox"/> http <input checked="" type="checkbox"/> SSH on port 22 <input type="checkbox"/> ftp
Coffee breaks (7.2)	<input checked="" type="checkbox"/> near the door <input type="checkbox"/> in cafeteria <input type="checkbox"/> another place: _____
Nearest toilet	average walking takes 1 minutes to reach the toilet <input checked="" type="checkbox"/> navigation signs to the toilet <input type="checkbox"/> toilet paper dispensers <input type="checkbox"/> soap dispensers <input type="checkbox"/> hand dryers <input type="checkbox"/> paper towels <i>toilet is located downstairs</i>
Walking distance to office	average walking takes 8 minutes to reach the IYPT office

Date 30.05.2016

Inspector's signature

LOC signature

International Young Physicists' Tournament  
European Physical Society  
6, rue des Frères Lumière  
68200 Mulhouse France

IBAN CH81 0900 0000 9133 0878 4  
BIC POFIGHBEXXX

<http://iypt.org>  
[info@iypt.org](mailto:info@iypt.org)



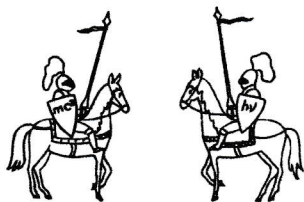

International Young Physicists' Tournament  
c/o European Physical Society  
6, rue des Frères Lumière  
68200 Mulhouse France  
email : [ilya.martchenko@iypt.org](mailto:ilya.martchenko@iypt.org)  
tel : +7 911 950 78 22

## 29th IYPT 2016 PF Room inspection checklist

Room door number	M-526
Tentative Group code	E
External navigation signs	<input type="checkbox"/> extensive <input type="checkbox"/> satisfactory <input checked="" type="checkbox"/> not yet mounted
Room type	<input checked="" type="checkbox"/> regular classroom <input type="checkbox"/> conference hall <input type="checkbox"/> library <input type="checkbox"/> amphitheater
Capacity teams (9.2, 9.3, 9.4)	<input checked="" type="checkbox"/> 3 teams only <input type="checkbox"/> 4 teams
Visitors (9.2, 9.3, 9.4)	chairs and space allow for seating of <u>10</u> visitors
Access for general public	<input type="checkbox"/> yes <input checked="" type="checkbox"/> only with an IYPT badge for pre-registered visitors
Data projectors (9.5)	ceiling mount projectors: <u>2</u> pcs portable projectors to be brought into the room: <u>0</u> pcs
PC for fight assistants (9.6)	<input checked="" type="checkbox"/> already in the room <input type="checkbox"/> will be brought later
External monitor for clock	<input checked="" type="checkbox"/> LCD panel in the room <input type="checkbox"/> data projector <input type="checkbox"/> will be brought later
Microphones	<input type="checkbox"/> no <input checked="" type="checkbox"/> yes, <u>1</u> pcs <i>fixed</i>
Boards / flipcharts (9.5)	<input checked="" type="checkbox"/> wall mount board <input checked="" type="checkbox"/> flipcharts to be brought into room
220 V power outlets (9.5)	<input checked="" type="checkbox"/> one power outlet per team member near their table
Wi-Fi connectivity	<input type="checkbox"/> no <input checked="" type="checkbox"/> yes, open <input checked="" type="checkbox"/> yes, restricted with password: _____
Accessibility of protocols	<input checked="" type="checkbox"/> http <input checked="" type="checkbox"/> SSH on port 22 <input type="checkbox"/> ftp
Coffee breaks (7.2)	<input checked="" type="checkbox"/> near the door <input type="checkbox"/> in cafeteria <input type="checkbox"/> another place: _____
Nearest toilet	average walking takes <u>1</u> minutes to reach the toilet <input type="checkbox"/> navigation signs to the toilet <input type="checkbox"/> toilet paper dispensers <input type="checkbox"/> soap dispensers <input type="checkbox"/> hand dryers <input type="checkbox"/> paper towels <i>Ladies toilet downstairs</i>
Walking distance to office	average walking takes <u>8</u> minutes to reach the IYPT office

Date

30.05.2016

Inspector's signature

LOC signature



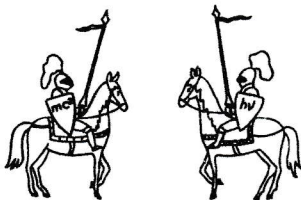

International Young Physicists' Tournament  
c/o European Physical Society  
6, rue des Frères Lumière  
68200 Mulhouse France  
email : ilya.martchenko@iypt.org  
tel : +7 911 950 78 22

## 29th IYPT 2016 PF Room inspection checklist

Room door number	M-527
Tentative Group code	F
External navigation signs	<input type="checkbox"/> extensive <input type="checkbox"/> satisfactory <input checked="" type="checkbox"/> not yet mounted
Room type	<input checked="" type="checkbox"/> regular classroom <input type="checkbox"/> conference hall <input type="checkbox"/> library <input type="checkbox"/> amphitheater
Capacity teams (9.2, 9.3, 9.4)	<input checked="" type="checkbox"/> 3 teams only <input type="checkbox"/> 4 teams (if needed, can be 4)
Visitors (9.2, 9.3, 9.4)	chairs and space allow for seating of 30 visitors
Access for general public	<input type="checkbox"/> yes <input checked="" type="checkbox"/> only with an IYPT badge for pre-registered visitors
Data projectors (9.5)	ceiling mount projectors: 2 pcs portable projectors to be brought into the room: 0 pcs
PC for fight assistants (9.6)	<input checked="" type="checkbox"/> already in the room <input type="checkbox"/> will be brought later
External monitor for clock	<input checked="" type="checkbox"/> LCD panel in the room <input type="checkbox"/> data projector <input type="checkbox"/> will be brought later
Microphones	<input type="checkbox"/> no <input checked="" type="checkbox"/> yes, 1 pcs fixed
Boards / flipcharts (9.5)	<input type="checkbox"/> wall mount board <input checked="" type="checkbox"/> flipcharts to be brought into room
220 V power outlets (9.5)	<input type="checkbox"/> one power outlet per team member near their table
Wi-Fi connectivity	<input type="checkbox"/> no <input checked="" type="checkbox"/> yes, open <input type="checkbox"/> yes, restricted with password: _____
Accessibility of protocols	<input checked="" type="checkbox"/> http <input type="checkbox"/> SSH on port 22 <input type="checkbox"/> ftp
Coffee breaks (7.2)	<input checked="" type="checkbox"/> near the door <input type="checkbox"/> in cafeteria <input type="checkbox"/> another place: _____
Nearest toilet	average walking takes 2 minutes to reach the toilet <input type="checkbox"/> navigation signs to the toilet <input type="checkbox"/> toilet paper dispensers <input type="checkbox"/> soap dispensers <input type="checkbox"/> hand dryers <input type="checkbox"/> paper towels Ladies toilet will be downstairs Groomed
Walking distance to office	average walking takes 8 minutes to reach the IYPT office

Date

30.07.2016

Inspector's signature

LOC signature

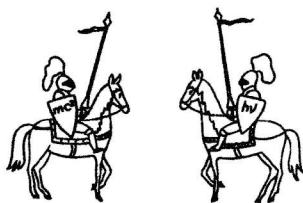

International Young Physicists' Tournament  
c/o European Physical Society  
6, rue des Frères Lumière  
68200 Mulhouse France  
email : ilya.martchenko@iypt.org  
tel : +7 911 950 78 22

## 29th IYPT 2016 PF Room inspection checklist

Room door number	M-538
Tentative Group code	G
External navigation signs	<input type="checkbox"/> extensive <input type="checkbox"/> satisfactory <input checked="" type="checkbox"/> not yet mounted
Room type	<input checked="" type="checkbox"/> regular classroom <input type="checkbox"/> conference hall <input type="checkbox"/> library <input type="checkbox"/> amphitheater
Capacity teams (9.2, 9.3, 9.4)	<input checked="" type="checkbox"/> 3 teams only <input type="checkbox"/> 4 teams
Visitors (9.2, 9.3, 9.4)	chairs and space allow for seating of 10 visitors
Access for general public	<input type="checkbox"/> yes <input checked="" type="checkbox"/> only with an IYPT badge for pre-registered visitors
Data projectors (9.5)	ceiling mount projectors: 2 pcs portable projectors to be brought into the room: 0 pcs
PC for fight assistants (9.6)	<input checked="" type="checkbox"/> already in the room <input type="checkbox"/> will be brought later
External monitor for clock	<input checked="" type="checkbox"/> LCD panel in the room <input type="checkbox"/> data projector <input type="checkbox"/> will be brought later
Microphones	<input type="checkbox"/> no <input checked="" type="checkbox"/> yes, 1 pcs fixed
Boards / flipcharts (9.5)	<input type="checkbox"/> wall mount board <input checked="" type="checkbox"/> flipcharts to be brought into room
220 V power outlets (9.5)	<input checked="" type="checkbox"/> one power outlet per team member near their table
Wi-Fi connectivity	<input type="checkbox"/> no <input checked="" type="checkbox"/> yes, open <input checked="" type="checkbox"/> yes, restricted with password: _____
Accessibility of protocols	<input checked="" type="checkbox"/> http <input type="checkbox"/> SSH on port 22 <input type="checkbox"/> ftp
Coffee breaks (7.2)	<input checked="" type="checkbox"/> near the door <input type="checkbox"/> in cafeteria <input type="checkbox"/> another place: _____
Nearest toilet	average walking takes 2 minutes to reach the toilet <input checked="" type="checkbox"/> navigation signs to the toilet <input type="checkbox"/> toilet paper dispensers <input type="checkbox"/> soap dispensers <input type="checkbox"/> hand dryers <input type="checkbox"/> paper towels Ladies' toilet downstairs
Walking distance to office	average walking takes 9 minutes to reach the IYPT office

Date

30.05.2016

Inspector's signature

LOC signature



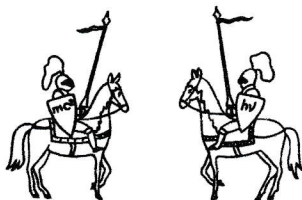

International Young Physicists' Tournament  
c/o European Physical Society  
6, rue des Frères Lumière  
68200 Mulhouse France  
email : ilya.martchenko@iypt.org  
tel : +7 911 950 78 22

## 29th IYPT 2016 PF Room inspection checklist

NB: Only this and 5-203 room allows for 4 teams!

Room door number	5-202
Tentative Group code	H
External navigation signs	<input type="checkbox"/> extensive <input type="checkbox"/> satisfactory <input checked="" type="checkbox"/> not yet mounted
Room type	<input type="checkbox"/> regular classroom <input type="checkbox"/> conference hall <input checked="" type="checkbox"/> library <input type="checkbox"/> amphitheater
Capacity teams (9.2, 9.3, 9.4)	<input type="checkbox"/> 3 teams only <input checked="" type="checkbox"/> 4 teams
Visitors (9.2, 9.3, 9.4)	chairs and space allow for seating of 50 visitors
Access for general public	<input type="checkbox"/> yes <input checked="" type="checkbox"/> only with an IYPT badge for pre-registered visitors
Data projectors (9.5)	ceiling mount projectors: 0 pcs portable projectors to be brought into the room: 2 pcs
PC for fight assistants (9.6)	<input type="checkbox"/> already in the room <input checked="" type="checkbox"/> will be brought later
External monitor for clock	<input checked="" type="checkbox"/> LCD panel in the room <input type="checkbox"/> data projector <input type="checkbox"/> will be brought later
Microphones	<input checked="" type="checkbox"/> no <input type="checkbox"/> yes, ___ pcs (if needed, can be arranged)
Boards / flipcharts (9.5)	<input checked="" type="checkbox"/> wall mount board <input checked="" type="checkbox"/> flipcharts to be brought into room
220 V power outlets (9.5)	<input checked="" type="checkbox"/> one power outlet per team member near their table
Wi-Fi connectivity	<input type="checkbox"/> no <input checked="" type="checkbox"/> yes, open <input checked="" type="checkbox"/> yes, restricted with password: _____
Accessibility of protocols	<input checked="" type="checkbox"/> http <input checked="" type="checkbox"/> SSH on port 22 <input type="checkbox"/> ftp
Coffee breaks (7.2)	<input checked="" type="checkbox"/> near the door <input type="checkbox"/> in cafeteria <input type="checkbox"/> another place: ?
Nearest toilet	average walking takes 2 minutes to reach the toilet <input type="checkbox"/> navigation signs to the toilet <input type="checkbox"/> toilet paper dispensers <input type="checkbox"/> soap dispensers <input type="checkbox"/> hand dryers <input type="checkbox"/> paper towels Orang Peak the entrance.
Walking distance to office	average walking takes 8 minutes to reach the IYPT office

Date

30.05.2016

Inspector's signature

LOC signature

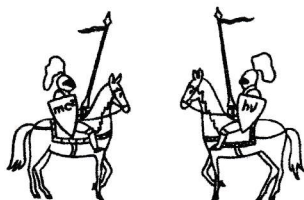

International Young Physicists' Tournament  
c/o European Physical Society  
6, rue des Frères Lumière  
68200 Mulhouse France  
email : [ilya.martchenko@iypt.org](mailto:ilya.martchenko@iypt.org)  
tel : +7 911 950 78 22

## 29th IYPT 2016 PF Room inspection checklist

*NB: Only this and B-202 allows for 4 teams*

Room door number	B-202
Tentative Group code	I
External navigation signs	<input type="checkbox"/> extensive <input type="checkbox"/> satisfactory <input checked="" type="checkbox"/> not yet mounted
Room type	<input type="checkbox"/> regular classroom <input type="checkbox"/> conference hall <input checked="" type="checkbox"/> library <input type="checkbox"/> amphitheater
Capacity teams (9.2, 9.3, 9.4)	<input type="checkbox"/> 3 teams only <input checked="" type="checkbox"/> 4 teams
Visitors (9.2, 9.3, 9.4)	chairs and space allow for seating of 50 visitors
Access for general public	<input type="checkbox"/> yes <input checked="" type="checkbox"/> only with an IYPT badge for pre-registered visitors
Data projectors (9.5)	ceiling mount projectors: 0 pcs portable projectors to be brought into the room: 2 pcs
PC for fight assistants (9.6)	<input type="checkbox"/> already in the room <input checked="" type="checkbox"/> will be brought later
External monitor for clock	<input checked="" type="checkbox"/> LCD panel in the room <input type="checkbox"/> data projector <input type="checkbox"/> will be brought later
Microphones	<input checked="" type="checkbox"/> no <input type="checkbox"/> yes, ___ pcs (can be arranged)
Boards / flipcharts (9.5)	<input type="checkbox"/> wall mount board <input checked="" type="checkbox"/> flipcharts to be brought into room
220 V power outlets (9.5)	<input checked="" type="checkbox"/> one power outlet per team member near their table
Wi-Fi connectivity	<input type="checkbox"/> no <input checked="" type="checkbox"/> yes, open <input checked="" type="checkbox"/> yes, restricted with password: _____
Accessibility of protocols	<input checked="" type="checkbox"/> http <input checked="" type="checkbox"/> SSH on port 22 <input type="checkbox"/> ftp
Coffee breaks (7.2)	<input checked="" type="checkbox"/> near the door <input type="checkbox"/> in cafeteria <input type="checkbox"/> another place: _____
Nearest toilet	average walking takes 2 minutes to reach the toilet <input checked="" type="checkbox"/> navigation signs to the toilet <input type="checkbox"/> toilet paper dispensers <input type="checkbox"/> soap dispensers <input type="checkbox"/> hand dryers <input type="checkbox"/> paper towels <i>Orange here the entrance</i>
Walking distance to office	average walking takes 8 minutes to reach the IYPT office

Date

*30.05.2016*

Inspector's signature

LOC signature



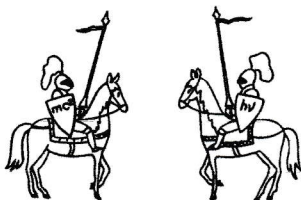

International Young Physicists' Tournament  
c/o European Physical Society  
6, rue des Frères Lumière  
68200 Mulhouse France  
email : ilya.martchenko@iypt.org  
tel : +7 911 950 78 22

## 29th IYPT 2016 PF Room inspection checklist

Room door number	Conference hall HYK-206
Tentative Group code	Final, Opening, Closing
External navigation signs	<input type="checkbox"/> extensive <input type="checkbox"/> satisfactory <input checked="" type="checkbox"/> not yet mounted
Room type	<input type="checkbox"/> regular classroom <input checked="" type="checkbox"/> conference hall <input type="checkbox"/> library <input type="checkbox"/> amphitheater
Capacity teams (9.2, 9.3, 9.4)	<input type="checkbox"/> 3 teams only <input checked="" type="checkbox"/> 4 teams
Visitors (9.2, 9.3, 9.4)	chairs and space allow for seating of 700 visitors
Access for general public	<input type="checkbox"/> yes <input checked="" type="checkbox"/> only with an IYPT badge for pre-registered visitors
Data projectors (9.5)	ceiling mount projectors: 2 pcs portable projectors to be brought into the room: 0 pcs
PC for fight assistants (9.6)	<input type="checkbox"/> already in the room <input checked="" type="checkbox"/> will be brought later
External monitor for clock	<input checked="" type="checkbox"/> LCD panel in the room <input checked="" type="checkbox"/> data projector <input type="checkbox"/> will be brought later
Microphones	<input type="checkbox"/> no <input checked="" type="checkbox"/> yes, 8 pcs wireless
Boards / flipcharts (9.5)	<input type="checkbox"/> wall mount board <input checked="" type="checkbox"/> flipcharts to be brought into room
220 V power outlets (9.5)	<input checked="" type="checkbox"/> one power outlet per team member near their table with extension cables
Wi-Fi connectivity	<input type="checkbox"/> no <input checked="" type="checkbox"/> yes, open <input checked="" type="checkbox"/> yes, restricted with password: _____
Accessibility of protocols	<input checked="" type="checkbox"/> http <input checked="" type="checkbox"/> SSH on port 22 <input type="checkbox"/> ftp
Coffee breaks (7.2)	<input checked="" type="checkbox"/> near the door <input type="checkbox"/> in cafeteria <input type="checkbox"/> another place: _____
Nearest toilet	average walking takes 1 minutes to reach the toilet downstairs <input type="checkbox"/> navigation signs to the toilet <input type="checkbox"/> toilet paper dispensers <input type="checkbox"/> soap dispensers <input type="checkbox"/> hand dryers <input type="checkbox"/> paper towels
Walking distance to office	average walking takes 5 minutes to reach the IYPT office

Date

30.07.2016

Inspector's signature

LOC signature



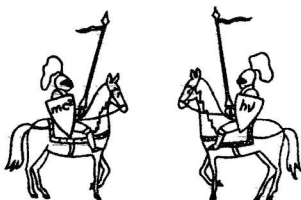

International Young Physicists' Tournament  
c/o European Physical Society  
6, rue des Frères Lumière  
68200 Mulhouse France  
email : [ilya.martchenko@iypt.org](mailto:ilya.martchenko@iypt.org)  
tel : +7 911 950 78 22

## 29th IYPT 2016 Office inspection checklist

Room door number	K325
220 V power outlets	wall power outlets: <u>6</u> pcs an expected extra with ____ extension cables: ____ pcs <i>as much as needed</i>
Wi-Fi connectivity (12.2)	<input type="checkbox"/> no <input checked="" type="checkbox"/> yes, open <input checked="" type="checkbox"/> yes, restricted with password: <u>it-physika</u>
Accessibility of protocols	<input checked="" type="checkbox"/> http <input checked="" type="checkbox"/> SSH on port 22 <input type="checkbox"/> ftp <i>not checked</i> <i>it-final</i>
Ethernet connectivity (12.2)	<input type="checkbox"/> no <input checked="" type="checkbox"/> yes
Mobile 3G SIM cards (12.2)	<input type="checkbox"/> yes <input checked="" type="checkbox"/> will be purchased later
Printer (12.2)	<input checked="" type="checkbox"/> A4 and A3 <i>color</i> printer with sheet fed scanner: <u>1</u> pcs <input checked="" type="checkbox"/> A4 black-and-white printer: ____ pcs <i>as much as needed</i>
2500 sheets A4 paper	<input type="checkbox"/> yes <input checked="" type="checkbox"/> will be purchased later
250 sheets A3 paper	<input type="checkbox"/> yes <input checked="" type="checkbox"/> will be purchased later
11 paper trays	<input type="checkbox"/> yes <input checked="" type="checkbox"/> will be purchased later
Data projectors <i>LCD panel</i>	projectors in the office: <u>1</u> pcs
Screen for coffee room	<input checked="" type="checkbox"/> LCD panel <input type="checkbox"/> data projector
PC / laptops	____ pcs <i>if needed</i>
Boards / flipcharts	<input checked="" type="checkbox"/> wall mount board <input checked="" type="checkbox"/> flipcharts to be brought into room
Coffee breaks	<input checked="" type="checkbox"/> near the door <input type="checkbox"/> in cafeteria <input type="checkbox"/> another place: ____
Nearest toilet	average walking takes <u>4</u> minutes to reach the toilet <i>as much as needed</i> <input type="checkbox"/> navigation signs to the toilet <input type="checkbox"/> toilet paper dispensers <input type="checkbox"/> soap dispensers <input type="checkbox"/> hand dryers <input type="checkbox"/> paper towels
Walking to groups	navigation signs: <input type="checkbox"/> extensive <input type="checkbox"/> satisfactory <input checked="" type="checkbox"/> not yet mounted walking takes <u>8</u> minutes to reach the most remote fight group

Date 30.05.2016

Inspector's signature *[Signature]*

LOC signature *[Signature]*

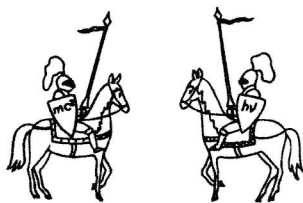

International Young Physicists' Tournament  
c/o European Physical Society  
6, rue des Frères Lumière  
68200 Mulhouse France  
email : ilya.martchenko@iypt.org  
tel : +7 911 950 78 22

## 29th IYPT 2016 dining hall inspection checklist

Room door number	Лаборатория - ТУК 115 Лаборатория
Special meals (7.1)	<input checked="" type="checkbox"/> vegetarian <input type="checkbox"/> halal <input type="checkbox"/> low fat, lactose free etc. <input checked="" type="checkbox"/> on prior demand only
External navigation signs	<input type="checkbox"/> extensive <input type="checkbox"/> satisfactory <input checked="" type="checkbox"/> not yet mounted
System of serving meals	<input checked="" type="checkbox"/> buffet <input type="checkbox"/> cafeteria-type counters <input type="checkbox"/> table service
Drinks self-service	<input checked="" type="checkbox"/> no <input type="checkbox"/> yes
Seating capacity	chairs and space allow for seating of <u>50</u> guests
Any participant allowed?	<input checked="" type="checkbox"/> no, only specific groups <input type="checkbox"/> yes
Service hours	<input type="checkbox"/> not flexible <input checked="" type="checkbox"/> flexible for late / early guests <u>± 30 min</u>
220 V power outlets	wall power outlets: <u>2</u> pcs
Wi-Fi connectivity	<input checked="" type="checkbox"/> no <input type="checkbox"/> yes, open <input type="checkbox"/> yes, restricted with password: _____
Nearest toilet	average walking takes <u>1</u> minutes to reach the toilet <input type="checkbox"/> navigation signs to the toilet <input type="checkbox"/> toilet paper dispensers <input type="checkbox"/> soap dispensers <input checked="" type="checkbox"/> hand dryers <input checked="" type="checkbox"/> paper towels
Walking to groups	navigation signs: <input type="checkbox"/> extensive <input type="checkbox"/> satisfactory <input checked="" type="checkbox"/> not yet mounted walking takes <u>8</u> minutes to reach the most remote fight group
Commentaries	<del>near enter only stay just &amp; loc</del> Only Ec & loc

Date 30.05.2016

Inspector's signature

LOC signature

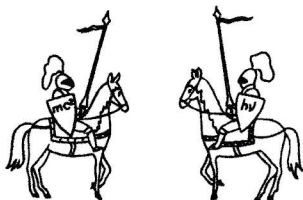

International Young Physicists' Tournament  
c/o European Physical Society  
6, rue des Frères Lumière  
68200 Mulhouse France  
email : ilya.martchenko@iypt.org  
tel : +7 911 950 78 22

## 29th IYPT 2016 dining hall inspection checklist

Room door number	11-330 Inache
Special meals (7.1)	<input checked="" type="checkbox"/> vegetarian <input type="checkbox"/> halal <input type="checkbox"/> low fat, lactose free etc. <input type="checkbox"/> on prior demand only
External navigation signs	<input type="checkbox"/> extensive <input type="checkbox"/> satisfactory <input checked="" type="checkbox"/> not yet mounted
System of serving meals	<input checked="" type="checkbox"/> buffet <input type="checkbox"/> cafeteria-type counters <input type="checkbox"/> table service
Drinks self-service	<input type="checkbox"/> no <input checked="" type="checkbox"/> yes
Seating capacity	chairs and space allow for seating of 90 guests
Any participant allowed?	<input checked="" type="checkbox"/> no, only specific groups <input type="checkbox"/> yes
Service hours	<input type="checkbox"/> not flexible <input checked="" type="checkbox"/> flexible for late / early guests ±30min
220 V power outlets	wall power outlets: 328 pcs
Wi-Fi connectivity	<input type="checkbox"/> no <input checked="" type="checkbox"/> yes, open <input type="checkbox"/> yes, restricted with password: _____
Nearest toilet	average walking takes 3 minutes to reach the toilet <input type="checkbox"/> navigation signs to the toilet <input type="checkbox"/> toilet paper dispensers will be mounted ! <input type="checkbox"/> soap dispensers <input checked="" type="checkbox"/> hand dryers <input checked="" type="checkbox"/> paper towels !
Walking to groups	navigation signs: <input type="checkbox"/> extensive <input type="checkbox"/> satisfactory <input checked="" type="checkbox"/> not yet mounted walking takes 3.8 minutes to reach the most remote fight group
Commentaries	<del>Only specific teams</del> <del>+ 2 very similar rooms</del> Only jury

Date 30.06.2016

Inspector's signature

LOC signature

International Young Physicists' Tournament  
European Physical Society  
6, rue des Frères Lumière  
68200 Mulhouse France

IBAN CH81 0900 0000 9133 0878 4  
BIC POFIGHBEXXX

<http://iypt.org>  
[info@iypt.org](mailto:info@iypt.org)



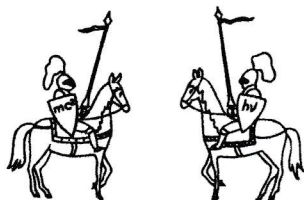

International Young Physicists' Tournament  
c/o European Physical Society  
6, rue des Frères Lumière  
68200 Mulhouse France  
email : ilya.martchenko@iypt.org  
tel : +7 911 950 78 22

## 29th IYPT 2016 dining hall inspection checklist

Room door number	Stolobova n 5
Special meals (7.1)	<input checked="" type="checkbox"/> vegetarian <input type="checkbox"/> halal <input type="checkbox"/> low fat, lactose free etc. <input type="checkbox"/> on prior demand only
External navigation signs	<input type="checkbox"/> extensive <input type="checkbox"/> satisfactory <input checked="" type="checkbox"/> not yet mounted
System of serving meals	<input checked="" type="checkbox"/> buffet <input type="checkbox"/> cafeteria-type counters <input type="checkbox"/> table service
Drinks self-service	<input type="checkbox"/> no <input checked="" type="checkbox"/> yes
Seating capacity	chairs and space allow for seating of 140 guests
Any participant allowed?	<input checked="" type="checkbox"/> no, only specific groups <input type="checkbox"/> yes
Service hours	<input type="checkbox"/> not flexible <input checked="" type="checkbox"/> flexible for late / early guests   ± 30 min
220 V power outlets	wall power outlets: 0 pcs
Wi-Fi connectivity	<input type="checkbox"/> no <input type="checkbox"/> yes, open <input checked="" type="checkbox"/> yes, restricted with password: ???
Nearest toilet	average walking takes 1 minutes to reach the toilet <input type="checkbox"/> navigation signs to the toilet <input type="checkbox"/> toilet paper dispensers <input checked="" type="checkbox"/> soap dispensers <input type="checkbox"/> hand dryers <input checked="" type="checkbox"/> paper towels + give walking order
Walking to groups	navigation signs: <input type="checkbox"/> extensive <input type="checkbox"/> satisfactory <input checked="" type="checkbox"/> not yet mounted walking takes 15 minutes to reach the most remote fight group
Commentaries	Only specific lemons (in alphabetical order) Sofa in the toilet → info will be available

Date

30.05.2015

Inspector's signature

LOC signature

International Young Physicists' Tournament  
European Physical Society  
6, rue des Frères Lumière  
68200 Mulhouse France

IBAN CH81 0900 0000 9133 0878 4  
BIC POFIGH33XXX

<http://iypt.org>  
[info@iypt.org](mailto:info@iypt.org)

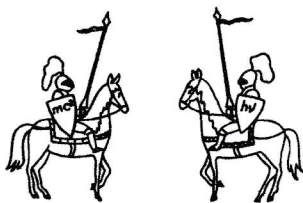

International Young Physicists' Tournament  
c/o European Physical Society  
6, rue des Frères Lumière  
68200 Mulhouse France  
email : ilya.martchenko@iypt.org  
tel : +7 911 950 78 22

## 29th IYPT 2016 dining hall inspection checklist

Room door number	Dieticheskiy 701 2 etazh
Special meals (7.1)	<input checked="" type="checkbox"/> vegetarian <input type="checkbox"/> halal <input type="checkbox"/> low fat, lactose free etc. <input checked="" type="checkbox"/> on prior demand only
External navigation signs	<input type="checkbox"/> extensive <input type="checkbox"/> satisfactory <input checked="" type="checkbox"/> not yet mounted
System of serving meals	<input checked="" type="checkbox"/> buffet <input type="checkbox"/> cafeteria-type counters <input type="checkbox"/> table service
Drinks self-service	<input type="checkbox"/> no <input checked="" type="checkbox"/> yes
Seating capacity	chairs and space allow for seating of 140 guests
Any participant allowed?	<input checked="" type="checkbox"/> no, only specific groups <input type="checkbox"/> yes
Service hours	<input type="checkbox"/> not flexible <input checked="" type="checkbox"/> flexible for late / early guests ± 30 min
220 V power outlets	wall power outlets: 4 pcs
Wi-Fi connectivity	<input type="checkbox"/> no <input type="checkbox"/> yes, open <input checked="" type="checkbox"/> yes, restricted with password: ??
Nearest toilet	average walking takes 1 minutes to reach the toilet <input checked="" type="checkbox"/> navigation signs to the toilet <input type="checkbox"/> toilet paper dispensers will be used <input checked="" type="checkbox"/> soap dispensers <input type="checkbox"/> hand dryers <input type="checkbox"/> paper towels
Walking to groups	navigation signs: <input type="checkbox"/> extensive <input type="checkbox"/> satisfactory <input checked="" type="checkbox"/> not yet mounted walking takes 15 minutes to reach the most remote fight group
Commentaries	Sofa in the toilet Only specific teams (in alphabetical order) → → info will be available

Date

30.05.2016

Inspector's signature

*[Signature]*

LOC signature

International Young Physicists' Tournament  
European Physical Society  
6, rue des Frères Lumière  
68200 Mulhouse France

IBAN CH81 0900 0000 9133 0878 4  
BIC POPHCHBEXXX

<http://iypt.org>  
[info@iypt.org](mailto:info@iypt.org)



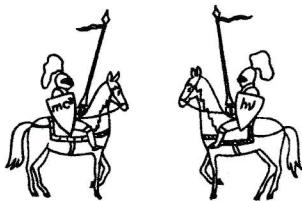

International Young Physicists' Tournament  
c/o European Physical Society  
6, rue des Frères Lumière  
68200 Mulhouse France  
email : [ilya.martchenko@iypt.org](mailto:ilya.martchenko@iypt.org)  
tel : +7 911 950 78 22

Dining hall : 70 seats now, 100 seats with tables.  
Buffet.

## 29th IYPT 2016 dormitory inspection checklist

*Dormitory N°5*

Address	<i>Lialysheva 144, Floors 5, 6, 9</i>
Guests per room (6.1, 6.3)	<input checked="" type="checkbox"/> max 3 team members per room <input checked="" type="checkbox"/> max 2 team leaders per room
Showers and toilets	one shower available per <u>6</u> guests one toilet available per <u>6</u> guests
Towels, bed linen (6.6)	<input checked="" type="checkbox"/> towels provided <input checked="" type="checkbox"/> bed linen provided <i>1 time replaced.</i>
Soap, toilet paper (6.6)	<input checked="" type="checkbox"/> soap provided <input checked="" type="checkbox"/> toilet paper provided
Preparation lounges (6.2)	<input checked="" type="checkbox"/> space for team meetings provided <i>5 lounges per 100 persons (one floor with sofas, chairs) + 1 large room with piano.</i>
Internet connectivity (6.6)	<input checked="" type="checkbox"/> Wi-Fi <input checked="" type="checkbox"/> wired Ethernet <i>(can be weaker near windows)</i>
Accessibility of protocols	<input checked="" type="checkbox"/> http <input type="checkbox"/> SSH on port 22 <input type="checkbox"/> ftp <i>(if needed)</i>
Drinking water dispensers	<input type="checkbox"/> no <input checked="" type="checkbox"/> yes <i>01<sup>00</sup> - 06<sup>00</sup> closed, only entry letters in the kitchen</i>
24/7 access to the building	<input type="checkbox"/> no <input type="checkbox"/> yes
One key per team member	<input checked="" type="checkbox"/> no <input type="checkbox"/> yes <i>one key per room, leave at exit</i>
Air conditioning	<input checked="" type="checkbox"/> no <input type="checkbox"/> yes
220 V power outlets	wall power outlets per room: <u>9</u> pcs + 4 outlets per unit
Grocery store nearby	<input type="checkbox"/> no <input checked="" type="checkbox"/> yes, 24/7 working hours <input checked="" type="checkbox"/> yes, open only <i>until 23<sup>00</sup>, big store</i>
Indoor vending machines	<input type="checkbox"/> no <input checked="" type="checkbox"/> yes, snacks and beverages <input checked="" type="checkbox"/> yes, coffee and hot drinks <i>water</i>
Walking distance to groups	walking takes <u>15</u> minutes to reach the most remote fight group
Commentaries	<i>2 volunteers will live in the dorm 24/7. 4 kitchen per floor. No cullery, no glassware &amp; fridge per unit, plastic balcony, etc. No smoking. 1 kettle per kitchen. Tea, coffee, 2 cooking stove. No English stuff. Breakfast in the same building. Showers. Garbage to trash bins.</i>

*on ground floor* *info desk*

Date

*31.05.2016*

Inspector's signature

LOC signature

International Young Physicists' Tournament  
European Physical Society  
6, rue des Frères Lumière  
68200 Mulhouse France

IBAN CH81 0900 0000 9133 0878 4  
BIC POFIGH33XXX

<http://iypt.org>  
[info@iypt.org](mailto:info@iypt.org)